

# Series NA valves and solenoid valves

3/2 - 5/2 - 5/3-way CC CO CP  
with holes configured according NAMUR standards



The pneumatic interface connection complies with NAMUR standards.  
These solenoid valves can be equipped with solenoids that are in compliance with UL or ATEX standards.

## GENERAL DATA

<b>Construction</b>	spool type (servo-pilot operated)
<b>Valve functions</b>	3/2-way NC, NO - 5/2-way - 5/3-way CC, CO, CP
<b>Materials</b>	AL body - stainless steel spool - NBR seals
<b>Mounting</b>	through 2 Ø5 holes in the valve body
<b>Ports</b>	2 - 4 = NAMUR 1 - 3 - 5 = G1/4
<b>Installation</b>	directly on a Namur Interface
<b>Operating temperature</b>	0 ÷ 60°C (using dry air -20°C)
<b>Operating pressure</b>	1,5 - 10 bar double solenoid 2,5 - 10 bar single solenoid
<b>Nominal pressure</b>	6 bar
<b>Nominal flow</b>	Qn = 1000 Nl/min
<b>Nominal diameter</b>	8 mm
<b>Fluid</b>	filtered air without lubrication. If lubricated air is used, it is recommended to use ISOVG32 oil, and to never interrupt the lubrication.

CODING EXAMPLE

NA	5	4N	-	15	-	02	IL	-	U7	7
NA	SERIES NAMUR									
5	NUMBER OF WAYS - POSITIONS: 3 = 3/2 NC 4 = 3/2 NO 5 = 5/2 6 = 5/3 CC 7 = 5/3 CO 8 = 5/3 CP									
4N	PORTS: 4N = G1/4 supply ports according NAMUR standards									
15	ACTUATION: 11 = double solenoid 15 = single solenoid, spring return 33 = pneumatic pneumatic 35 = pneumatic, spring									
02	SOLENOID INTERFACE: 02 = mech. sol. 22 x 22									
IL	TYPE OF MANUAL OVERRIDE: = bistable, standard IL = bistable, lever type (available on demand) IM = monostable (available on demand)									
U7	SOLENOID MATERIAL / SOLENOID DIMENSIONS: A8 = PPS / 30 x 30 G7 = PA / 22 x 22 G8 = PA / 30 x 30 (24 V DC only) G9 = PA / 22 x 58 H8 = Self-extinguishing PA, Explosion-proof / 30 x 30 U7 = PET / 22 x 22									
7	SOLENOID VOLTAGE (see the dedicated section 2.35)									

TYPES OF MANUAL OVERRIDE

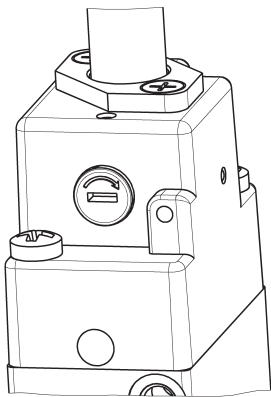

Example of solenoid valve with a bistable standard manual override.

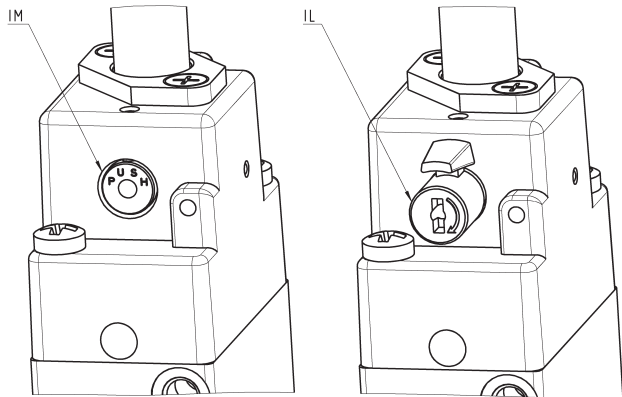

Example of solenoid monostable valve (IM) and bistable valve with a lever type manual override (IL).

### 5/3-way solenoid valve CC CO CP

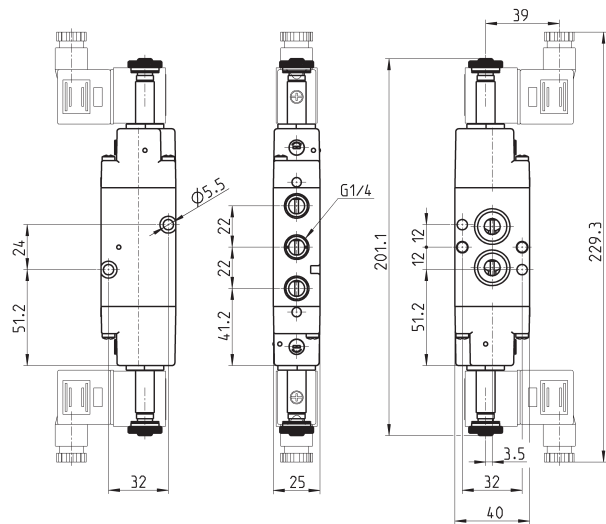
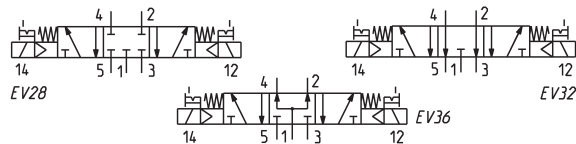

Mod.	Symbol
NA64N-11-02	EV28
NA74N-11-02	EV32
NA84N-11-02	EV36

### 5/2-way pneumatic valve, bistable

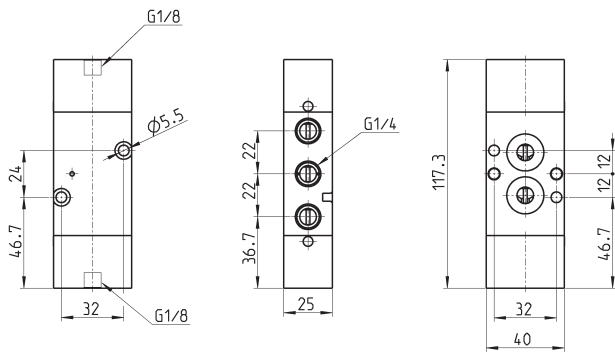
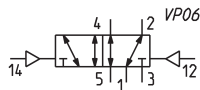

Mod.
NA54N-33

5/2-way pneumatic valve, monostable

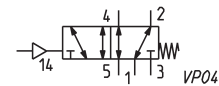
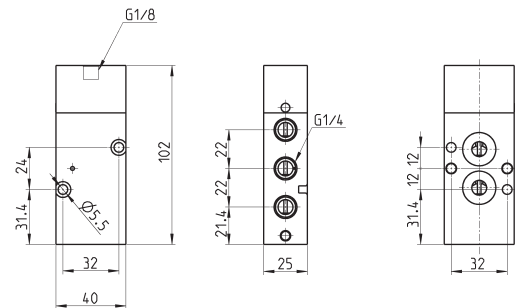

Mod.
NA54N-35

5/3-way pneumatic valve CC CO CP

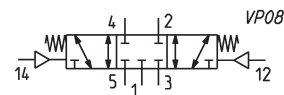
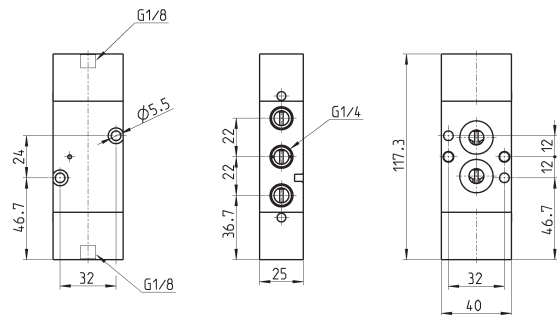

Mod.	
NA64N-33	VP08
NA74N-33	VP09
NA84N-33	VP10

Single subbase Mod. NA54-PC



Distance plate for the mounting of Series H8 solenoids

Supplied with:  
2x screws  
2x O-rings

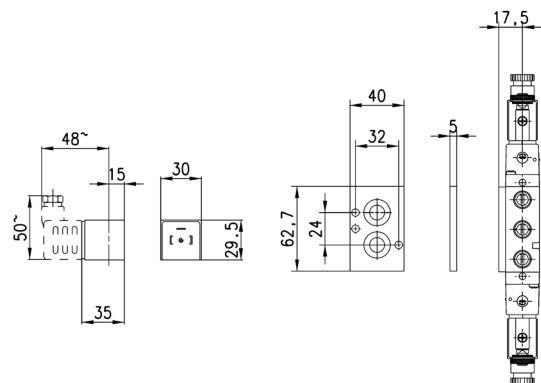

Mod.
NA54-PC