

Series K8B

pilot operated solenoid valves

2/2-way - Normally Closed (NC) and Normally Open (NO)

3/2-way - Normally Closed (NC) and Normally Open (NO)



- » Compact design
- » High flow
- » Manifold mounting
- » Long life

Thanks to their low power consumption and light weight Series K8B solenoid valves are particularly suitable for use with portable equipment too.

Series K8B pilot operated solenoid valves represent the evolution of Series K8 which has been equipped with a flow amplifier. Their particular design makes these valves ideal for use in applications requiring very compact solutions and high flow.

GENERAL DATA

TECHNICAL FEATURES

Function	2/2 NC - 2/2 NO - 3/2 NC - 3/2 NO
Operation	pilot operated poppet type
Pneumatic connections	cartridge seat in manifold - M7 threads - on subbase
Orifice diameter	3.6 mm
Flow coefficient kv (l/min)	2.8
Operating pressure	1 ÷ 7 bar
Operating temperature	0 ÷ 50 °C
Media	filtered compressed air, unlubricated, according to ISO 8573-1 class 2.4.2, inert gas
Response time (ISO 12238)	ON <15 ms - OFF <15 ms
Installation	in any position

MATERIALS IN CONTACT WITH THE MEDIUM

Body	brass - stainless steel - PBT - aluminium
Seals	FKM
Internal parts	stainless steel - enamelled copper

ELECTRICAL FEATURES

Voltage	3 ... 24 V DC - other voltages on demand
Voltage tolerance	±10%
Power consumption	0.6 W
Duty cycle	ED 100%
Electrical connection	2 pins 0.5 x 0.5 pitch 4 mm - JST connector with 300 mm flying leads
Protection class	IP00

Special versions available on demand

CODING EXAMPLE

K8B	C5	4	00	-	D4	3	2	N	-	N	00	1A	C003
K8B	SERIES												
C5	BODY DESIGN C0 = valve with aluminium body flanged connections C3 = valve with aluminium body threaded connections C5 = cartridge valve without body												
4	NUMBER OF WAYS - FUNCTIONS 1 = 2/2-way - NC 2 = 2/2-way - NO 4 = 3/2-way - NC 5 = 3/2-way - NO												
00	PNEUMATIC CONNECTIONS 00 = cartridge seat in manifold 03 = M7 thread 18 = 2/2-way K8B-type interface 19 = 3/2-way K8B-type interface												
D4	ORIFICE DIAMETER D4 = Ø 3.6mm												
3	SEALS MATERIALS 3 = FKM												
2	MATERIALS 1 = stainless steel - brass - aluminium (valve with body version) 2 = stainless steel - brass (cartridge version)												
N	MANUAL OVERRIDE N = not foreseen												
N	FIXING N = not foreseen P = screws for plastics M = screws for metal												
00	OPTION 00 = no option												
1A	ELECTRICAL CONNECTION 2 = pins - pitch 4 mm 3 = JST connector with 300 mm flying leads												
C003	VOLTAGE - POWER CONSUMPTION C001 = 6 V DC (0.6 W) C002 = 12 V DC (0.6 W) C003 = 24 V DC (0.6 W)												
	OPTIONS: = standard OX1 = for use with oxygen (non volatile residual less than 550 mg/m ³)												

AVAILABLE FUNCTIONS

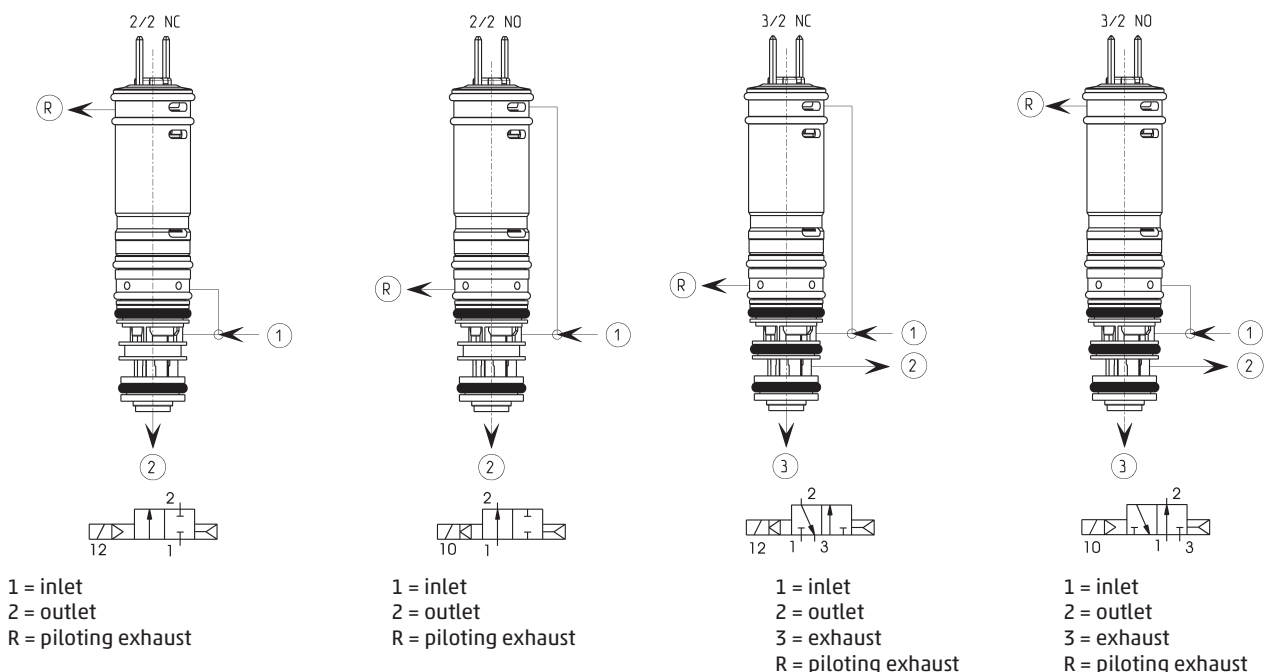

Solenoid valve Series K8B - cartridge version



* add
- VOLTAGE
(see CODING EXAMPLE)

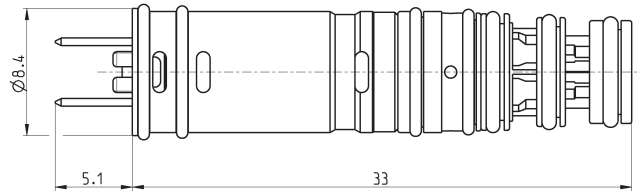

	Function	Orifice Ø (mm)	kv (l/min)	Min+max pressure (bar)
K8BC5100-D432N-N001A [°]	2/2 NC	3.6	2.8	1÷7
K8BC5200-D432N-N001A [°]	2/2 NO	3.6	2.8	1÷7
K8BC5400-D432N-N001A [°]	3/2 NC	3.6	2.8	1÷7
K8BC5500-D432N-N001A [°]	3/2 NO	3.6	2.8	1÷7

Series K8B - seat dimensions cartridge version

To achieve the declared flow rate it is necessary to realize the ports with a section of 12.5 mm^2 (equal to a diameter of 4 mm)

* for the 2/2 version this operation has not to be performed

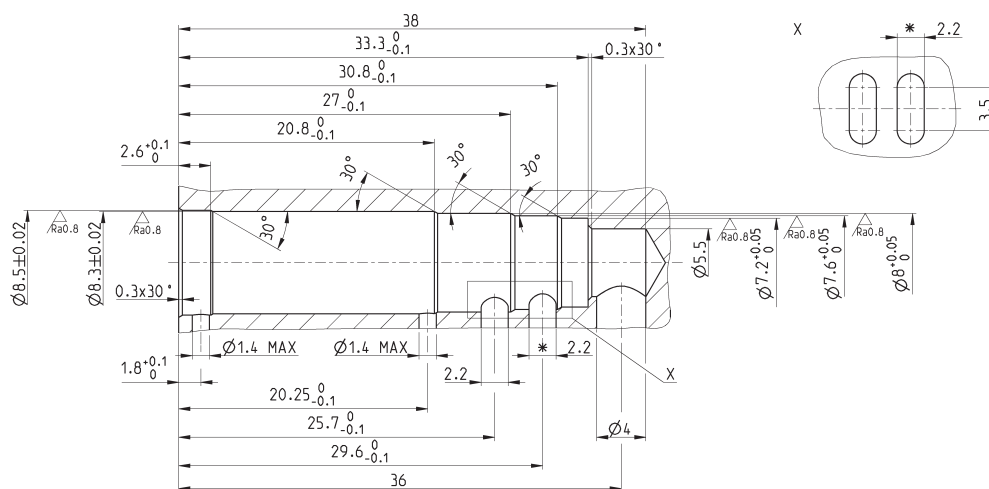

Series K8B solenoid valve - 2/2-way - threaded ports body version



Supplied with:
1x connector with flying leads
Mod. 120-J803 (300mm)

* add
- VOLTAGE
(see CODING EXAMPLE)

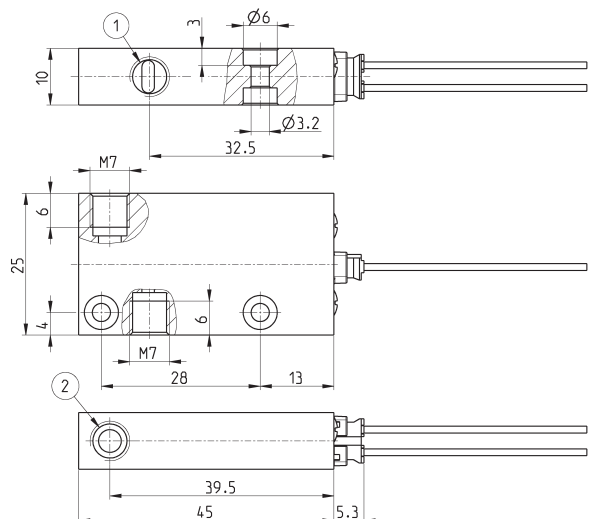
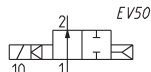
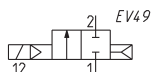

Mod.	Function	Orifice Ø (mm)	kv (l/min)	Min÷max pressure (bar)
K8BC3103-D431N-N001B*	2/2 NC	3.6	2.8	1÷7
K8BC3203-D431N-N001B*	2/2 NO	3.6	2.8	1÷7

Series K8B solenoid valve - 3/2-way - threaded ports body version



Supplied with:
1x connector with flying leads
Mod. 120-J803 (300mm)

* add
- VOLTAGE
(see CODING EXAMPLE)

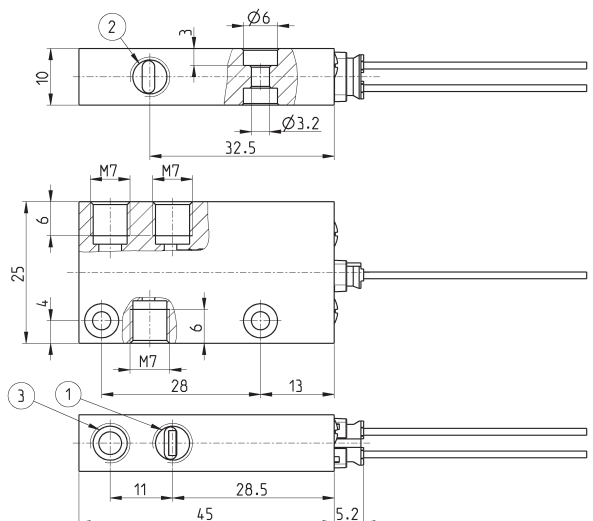
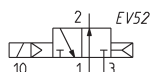
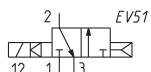

Mod.	Function	Orifice Ø (mm)	kv (l/min)	Min÷max pressure (bar)
K8BC3403-D431N-N001B*	3/2 NC	3.6	2.8	1÷7
K8BC3503-D431N-N001B*	3/2 NO	3.6	2.8	1÷7

Series K8B solenoid valve - 2/2-way - flanged body version



Supplied with:
1x connector with flying leads
Mod. 120-J803 (300mm)
2x interface seals
2x M3x6 screws for mounting on metal
or
2x Ø3x6 screws for mounting on plastic

* add
- FIXING
- VOLTAGE
(see CODING EXAMPLE)

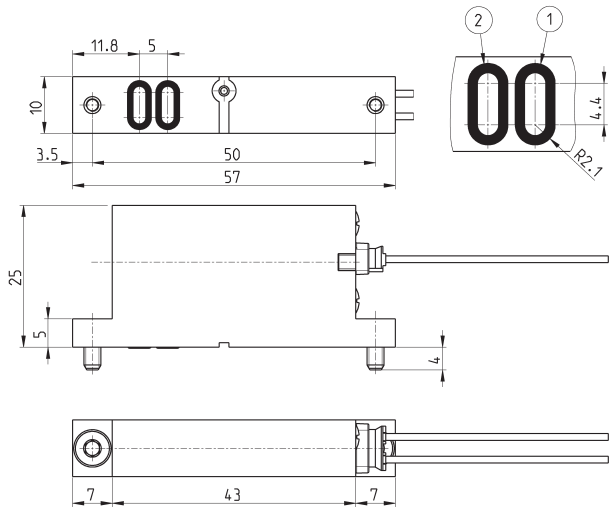
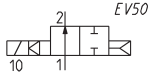
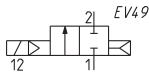

Mod.	Function	Orifice Ø (mm)	kv (l/min)	Min÷max pressure (bar)
K8BC0118-D431N-*001B*	2/2 NC	3.6	2.8	1÷7
K8BC0218-D431N-*001B*	2/2 NO	3.6	2.8	1÷7

Series K8B solenoid valve - 3/2-way - flanged body version



Supplied with:
1x connector with flying leads
Mod. 120-J803 (300mm)
3x interface seals
2x M3x6 screws for mounting on metal
or
2x Ø3x6 screws for mounting on plastic

* add
- FIXING
- VOLTAGE
(see CODING EXAMPLE)

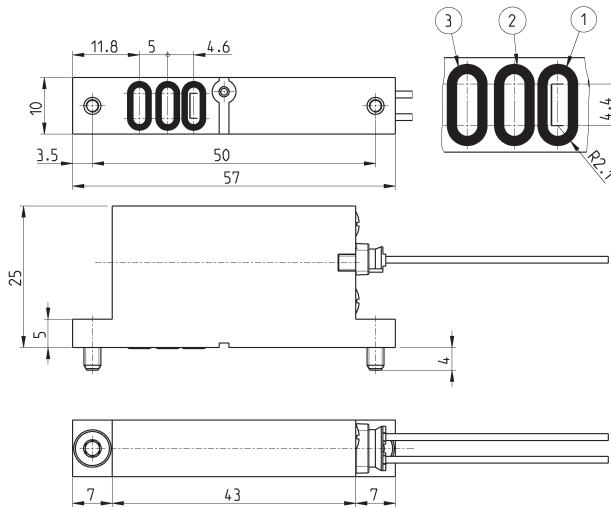
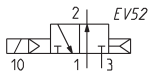
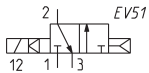

Mod.	Function	Orifice Ø (mm)	kv (l/min)	Min÷max pressure (bar)
KBC0419-D431N-*001B*	3/2 NC	3.6	2.8	1÷7
KBC0519-D431N-*001B*	3/2 NO	3.6	2.8	1÷7

Connector with flying leads Mod. 120-J...



Flying leads section: 0.22 mm²
 Flying lead external diameter: 1.1 mm
 Material for the flying leads insulation: PVC

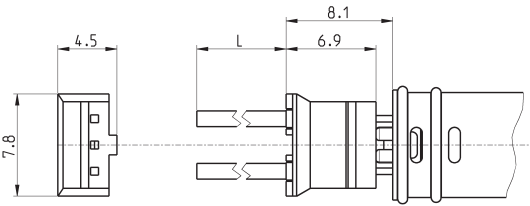

Mod.	description	colour	L = cable length (mm)	cable holding
120-J803	crimped cable connector J	white	300	crimping
120-J806	crimped cable connector J	white	600	crimping