

# Series 4 valves and solenoid valves

New models

3/2, 5/2 and 5/3-way CC, CO  
Ports: G1/8, G1/4, G3/8, G1/2



Series 4 solenoid valves have been designed in the 3/2, 5/2, 5/3 versions and with the following two devices of actuation:

- electropneumatically actuated with mechanical spring return
- electropneumatically actuated and return with external and internal air pressure supply

Series 4 valves are equipped with a manual override which allows a stable operation and they are particularly suitable for mounting in arduous conditions.

All these valves can be operated by solenoids Series U, G A8 and H8.

Pneumatically actuated valves 3/2 NC become NO when the supply is on connection 3.

- » The different ports allow flows from 650 to 4000 NL/min
- » New models available: with G3/8 ports and 1800 NL/min flow

## GENERAL DATA

Construction	balanced spool type
Valve functions	3/2 - 5/2 - 5/3-way CC, CO
Materials	AL body and subbases stainless steel spool technopolymer end cover NBR PU seals
Ports	G1/8 - G1/4 - G3/8 - G1/2
Installation	in any position
Operating temperature	0 ÷ 60°C (with dry air at -20°C)
Operating pressure	see table
Medium	filtered air, without lubrication. If lubricated air is used, it is recommended to use ISOVG32 oil. Once applied the lubrication should never be interrupted.

**5/2-way valve, G1/2 port, bistable Mod. 452N-33**

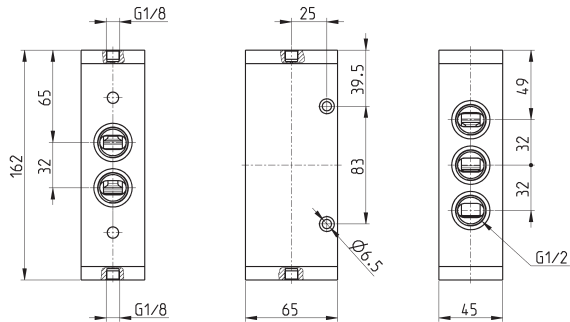
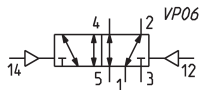

Mod.	Mounting	Function	Flow rate Qn (NL/min)	min. pilot Pressure (bar)	Working pressure (bar)	Symbol
452N-33	in-line	5/2	4000	2	-0.9 ÷ 10	VP06

**Manifold base with common exhausts**



For valves Series 4, G1/8 (3/2, 5/2 or 5/3-way)  
The following is supplied with:  
1x manifold  
1x pair of fixing screws for valve position  
1x interface seal for valve positions  
2x guides for valve position

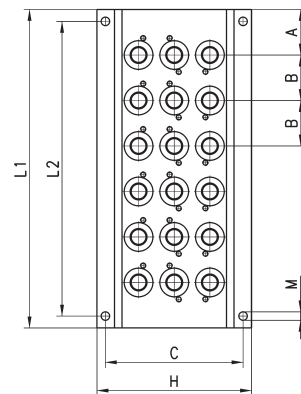
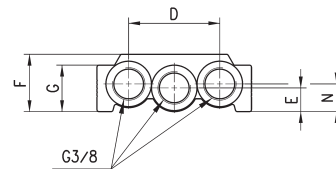

DIMENSIONS												
Mod.	A	B	C	D	E	F	G	H	L1	L2	M	N
CNVL-42	28	33	69.2	46	12	29	23.5	78	89	77	4.3	14
CNVL-43	28	33	69.2	46	12	29	23.5	78	122	110	4.3	14
CNVL-44	28	33	69.2	46	12	29	23.5	78	155	143	4.3	14
CNVL-45	28	33	69.2	46	12	29	23.5	78	188	176	4.3	14
CNVL-46	28	33	69.2	46	12	29	23.5	78	221	209	4.3	14

## Manifold base with common exhausts



For valves Series 4, G1/4 (3/2, 5/2 or 5/3-way)  
The following is supplied :  
1x manifold  
1x pair of fixing screws for valve position  
1x interface seal for valve positions  
2x guides for valve position

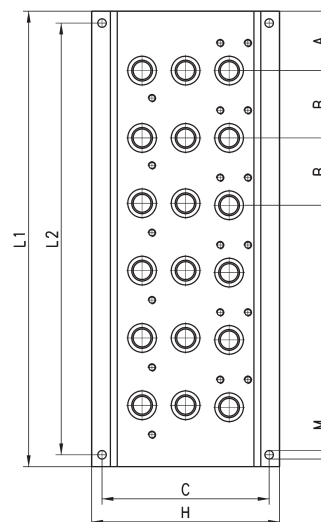
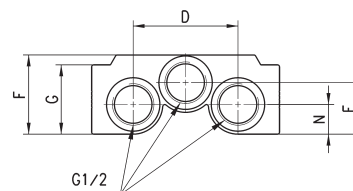

DIMENSIONS												
Mod.	A	B	C	D	E	F	G	H	L1	L2	M	N
CNVL-52	30	34	84.5	53	26	40	35	95	94	82	4.3	15
CNVL-53	30	34	84.5	53	26	40	35	95	128	116	4.3	15
CNVL-54	30	34	84.5	53	26	40	35	95	162	150	4.3	15
CNVL-55	30	34	84.5	53	26	40	35	95	196	184	4.3	15
CNVL-56	30	34	84.5	53	26	40	35	95	230	218	4.3	15

## Manifold base with common exhausts

**New**



For valves Series 4, G3/8 (3/2, 5/2 or 5/3-way)  
The following is supplied with:  
1x manifold  
1x pair of fixing screws for valve position  
1x interface seal for valve positions  
2x guides for valve position

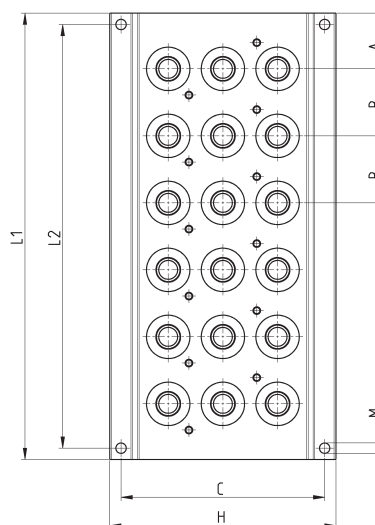
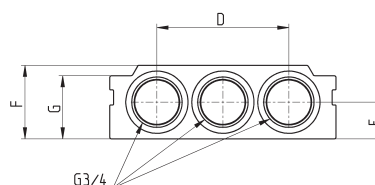

Mod.	A	B	C	D	E	F	G	H	L1	L2	M
CNVL-62	29.5	35	108	70	19.5	39	33.5	120	94.5	82.5	5.5
CNVL-63	29.5	35	108	70	19.5	39	33.5	120	130	118	5.5
CNVL-64	29.5	35	108	70	19.5	39	33.5	120	166	154	5.5
CNVL-65	29.5	35	108	70	19.5	39	33.5	120	201	189	5.5
CNVL-66	29.5	35	108	70	19.5	39	33.5	120	237	225	5.5

**Blanking plug Mod. TCNVL for manifolds**



The following is supplied:  
1x blanking plug  
1x O-Ring

TCNVL/3: for Series 4, G1/8  
TCNVL/5: for Series 4, G1/4  
TCNVL/6: for Series 4, G3/8

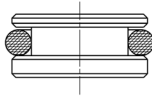

Mod.
TCNVL/3
TCNVL/5
TCNVL/6

**Blanking plate Mod. CNVL for manifolds**



The following is supplied:  
2x fixing screws  
3x O-Rings

CNVL/2: for Series 4, G1/8  
CNVL/3: for Series 4, G1/4  
CNVL/6: for Series 4, G3/8

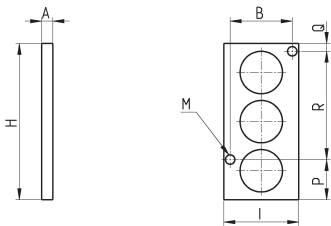

DIMENSIONS								
Mod.	A	B	H	I	M	P	Q	R
CNVL/2	5	25.6	52	32	4.2	17	17	18
CNVL/3	5	27.8	70	33.5	4.2	18	3.5	48.5
CNVL/6	5	27.8	85	33.5	4.2	24.5	24.5	36

It is used to blank vacant positions of a manifold.